



City of BUNKER HILL VILLAGE NEWSLETTER

PUBLISHED BY THE CITY OF BUNKER HILL VILLAGE | WWW.BUNKERHILLTX.GOV

Memorial Drive to be Closed for Bridge Reconstruction *Monday, April 11, 2016* *9:00 a.m.* *Weather Permitting*

Memorial Drive in Bunker Hill Village will be closed on **Monday, April 11, 2016 at 9:00 a.m.** after the morning rush hour pending any problematic weather conditions. The closure will allow for the reconstruction of the bridge across the drainage way (W151) located near the Memorial Forest Club (east of the intersection of Gessner Road and Memorial Drive). This timeframe was selected to accommodate the school schedule for Frostwood and Bunker Hill Elementary Schools. Memorial Drive will be reopened in time for the new school year in August 2016.

Traffic will be detoured via Briar Forest Drive on the south, Barryknoll Lane on the north connected by Gessner Road on the west. (See below)

The Texas Department of Transportation (TxDOT) will be managing this preventative maintenance project - the original bridge was built in 1965.

We certainly understand the inconvenience that will come with this project. Though inconvenienced for several months, we hope you understand the need to ensure the safety of our roadway and bridge structures. The end result is a new bridge to last another 50+ years.

Again, we thank you in advance for your patience and understanding of this safety project.

~ Karen Glynn, City Administrator

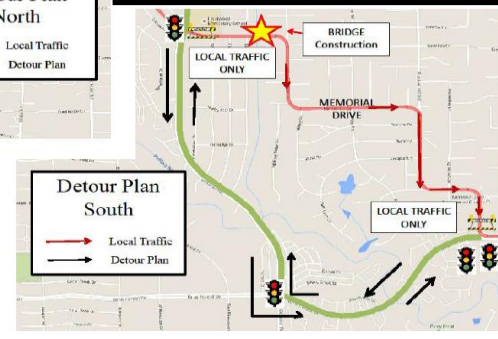
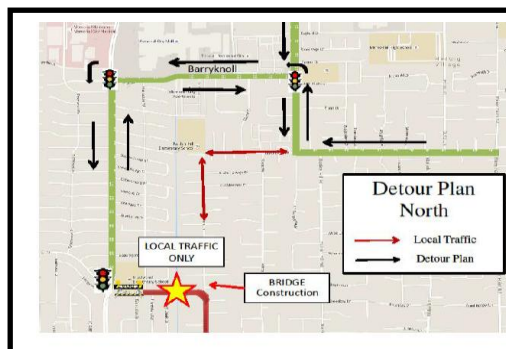
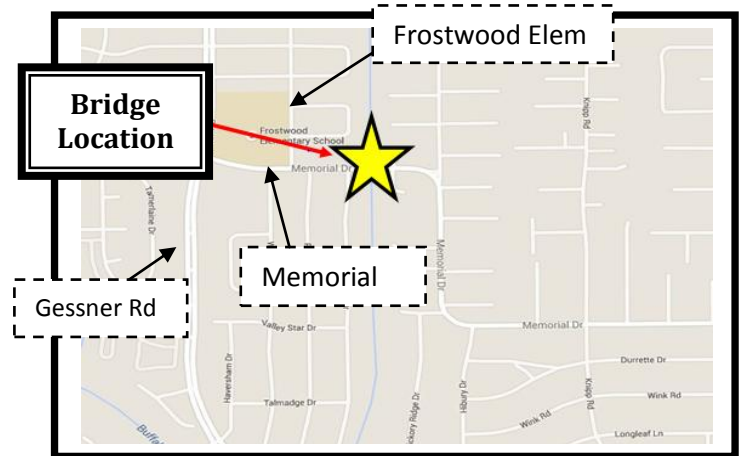

"Local Traffic" is defined as anyone who has a destination within the Bunker Hill/Memorial Drive area such as all residents and visitors accessing their homes, churches, and schools. The actual closure is at the bridge location. All streets, homes, churches, and schools will continue to have access.